

PNP General Purpose Amplifier

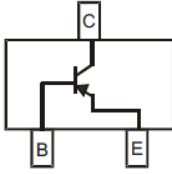

SOT-323

Features

- Epoxy meets UL-94 V-0 flammability rating and halogen free
- Moisture Sensitivity Level 1
- Part no. with suffix "Q" means AEC-Q101 qualified

Applications

- General purpose switching and amplification

Mechanical Data

- Case: SOT-323
- Terminals: Tin plated leads, solderable per J-STD-002 and JESD22-B102
- Marking:

BC807-16WQ	5A
BC807-25WQ	5B
BC807-40WQ	5C

■Maximum Ratings (Ta=25°C Unless otherwise specified)

Item	Symbol	Unit	Value
Collector-Emitter Voltage	V_{CEO}	V	-45
Collector-Base Voltage	V_{CBO}	V	-50
Emitter-Base Voltage	V_{EBO}	V	-5.0
Collector Current	I_C	A	-0.5
Total Device Dissipation (*)	P_D	mW	200
Thermal Resistance from Junction to Ambient (*)	$R_{\theta JA}$	°C/W	625
Operation Junction Temperature	T_j	°C	150
Storage Temperature	T_{stg}	°C	-55 to +150

(*) Device mounted on FR-4 PCB 1.0 x 1.0 x 0.06 inch



BC807-16WQ THRU BC807-40WQ

■ Electrical Characteristics (Ta=25°C unless otherwise specified)

Item	Symbol	Unit	Conditions	Min	Max	
Collector-Emitter Voltage	V_{CE0}	V	$I_C = -10mA, I_B = 0$	-45		
Collector-Base Voltage	V_{CBO}	V	$I_C = -10uA, I_E = 0$	-50		
Emitter-Base Voltage	V_{EBO}	V	$I_E = -1.0uA, I_C = 0$	-5.0		
Emitter-base Cut-off Current	I_{EBO}	uA	$V_{EB} = -4.0V, I_C = 0$		-0.1	
Collector -base Cut-off Current	I_{CBO}	uA	$V_{CB} = -45V, I_E = 0$		-0.1	
DC Current Gain	h_{FE}		BC807-16WQ	$V_{CE} = -1.0V, I_C = -100mA$	100	250
			BC807-25WQ		160	400
			BC807-40WQ		250	600
DC Current Gain	h_{FE}		$V_{CE} = -1.0V, I_C = -500mA$	40		
Collector-Emitter Saturation Voltage	$V_{CE(sat)}$	V	$I_C = -500mA, I_B = -50mA$		-0.7	
Base-Emitter Saturation Voltage	$V_{BE(sat)}$	V	$I_C = -500mA, I_B = -50mA$		-1.2	

■ Small-signal Characteristics

Item	Symbol	Unit	Conditions	Min	Max
Transition frequency	f_T	MHz	$I_C = -10mA, V_{CE} = -5.0V, f = 100MHz$	100	

■ Ordering Information (Example)

Preferred P/N	Packing Code	Unit Weight(G)	Minimum Package(Pcs)	Inner Box Quantity(Pcs)	Outer Carton Quantity(Pcs)	Delivery Mode
BC807-16WQ THRU BC807-40WQ	F2	Approximate 0.005	3000	30000	120000	7" reel



BC807-16WQ THRU BC807-40WQ

■ Characteristics (Typical)

Fig.1 - Static characteristic

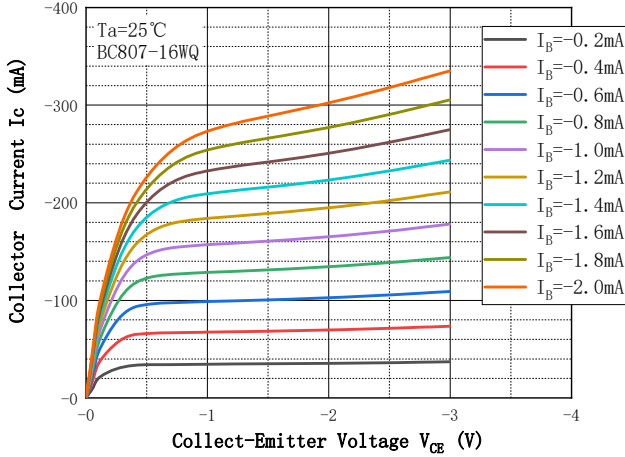

Fig.2 - DC Current Gain

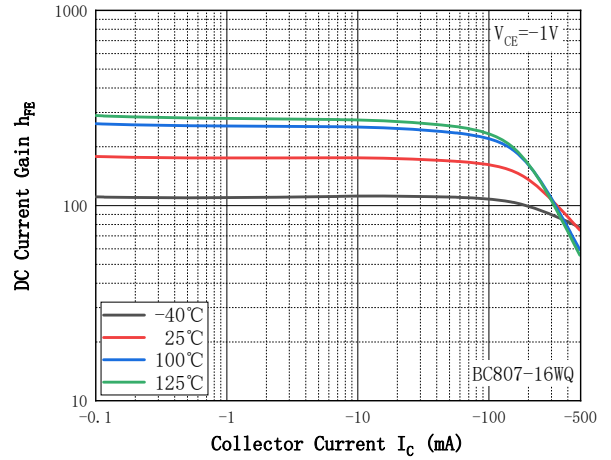

Fig.3 - Collect-Emittor Saturation Voltage

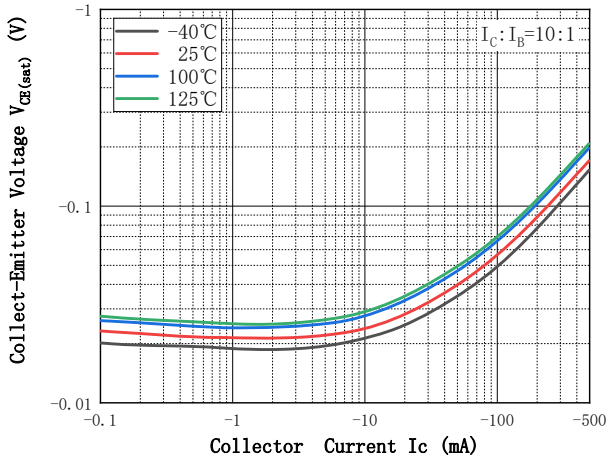

Fig.4 - Base-Emittor Voltage

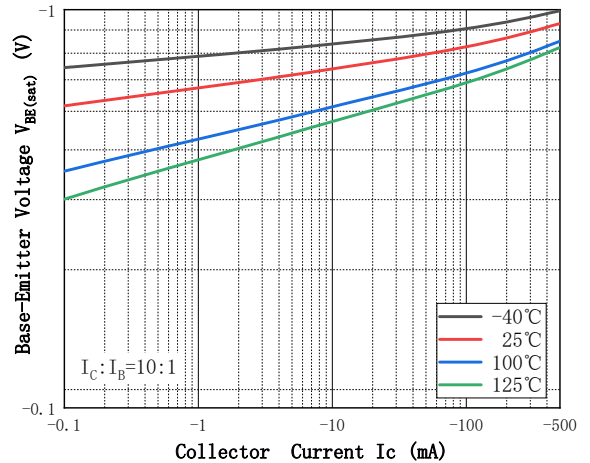

Fig.5 - Base-Emittor On Voltage

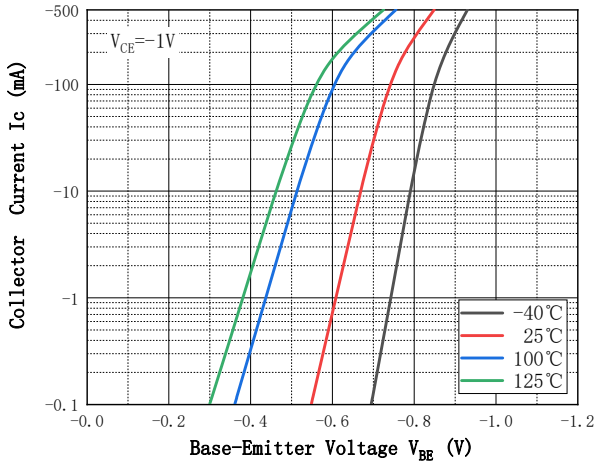
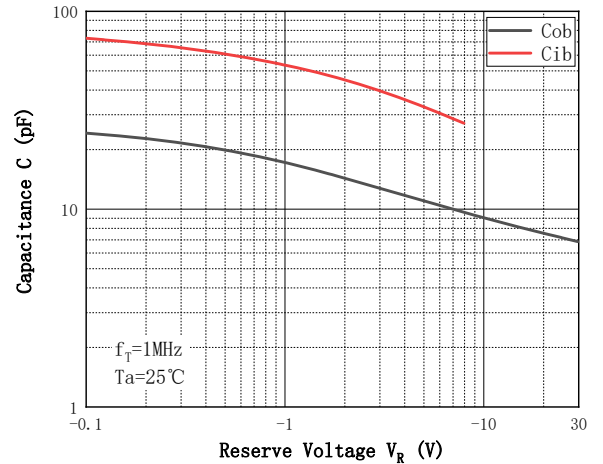

Fig.6 - Cob/Cib—VCB/VEB





BC807-16WQ THRU BC807-40WQ

■ SOT-323 Package Outline Dimensions & Suggested Pad Layout

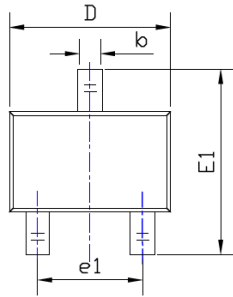

TOP VIEW

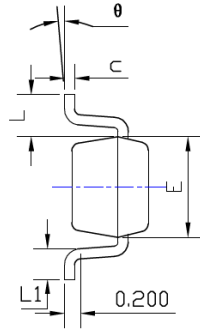

SIDE VIEW

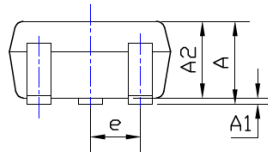

SIDE VIEW

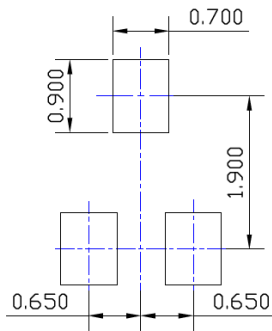

UNIT: mm

SUGGESTED SOLDER PAD LAYOUT

SYMBOL	DIMENSIONS			
	INCHES		Millimeter	
	MIN.	MAX.	MIN.	MAX.
A	0.035	0.043	0.900	1.100
A1	0.000	0.004	0.000	0.100
A2	0.035	0.039	0.900	1.000
b	0.006	0.016	0.150	0.400
c	0.004	0.010	0.100	0.250
D	0.071	0.087	1.800	2.200
E	0.045	0.053	1.150	1.350
E1	0.085	0.096	2.150	2.450
e	0.026TYP		0.650TYP	
e1	0.047	0.055	1.200	1.400
L	0.021REF		0.525REF	
L1	0.010	0.018	0.260	0.460
theta	0°	8°	0°	8°

NOTE:

1. PACKAGE BODY SIZES EXCLUDE MOLD FLASH AND GATE BURRS.
2. TOLERANCE 0.1mm UNLESS OTHERWISE SPECIFIED.
3. THE PAD LAYOUT IS FOR REFERENCE PURPOSES ONLY.



BC807-16WQ THRU BC807-40WQ

Disclaimer

The information presented in this document is for reference only. Yangzhou Yangjie Electronic Technology Co., Ltd. reserves the right to make changes without notice for the specification of the products displayed herein to improve reliability, function or design or otherwise.

The product listed herein is designed to be used with automotive electronics, are not designed for use in medical, life-saving, lifesustaining, or military, Yangjie or anyone on its behalf, assumes no responsibility or liability for any damages resulting from such improper use of sale.

This publication supersedes & replaces all information previously supplied. For additional information, please visit our website [http:// www.21yangjie.com](http://www.21yangjie.com) , or consult your nearest Yangjie's sales office for further assistance.



BC807-16WQ THRU BC807-40WQ

ISSUE	REVISION	DATE
1.0	New datasheet	26-Oct-22